

NO.	DOCUMENT ISSUE	DATE

NO.	REVISIONS	DATE

PHASE ISSUE BLOCK
CONSTRUCTION DOCUMENTS

SIGNATURE AND SEAL BLOCK

SHEET TITLE	
SITE PLAN	
PROJECT ARCHITECT	SYLLA PROJECT NO.
JAG	05003
PROJECT MANAGER	DATE
CTS	6-5-06
DRAWN BY	SHEET NO.
CAD	A1-1
CHECKED BY	
CTS	

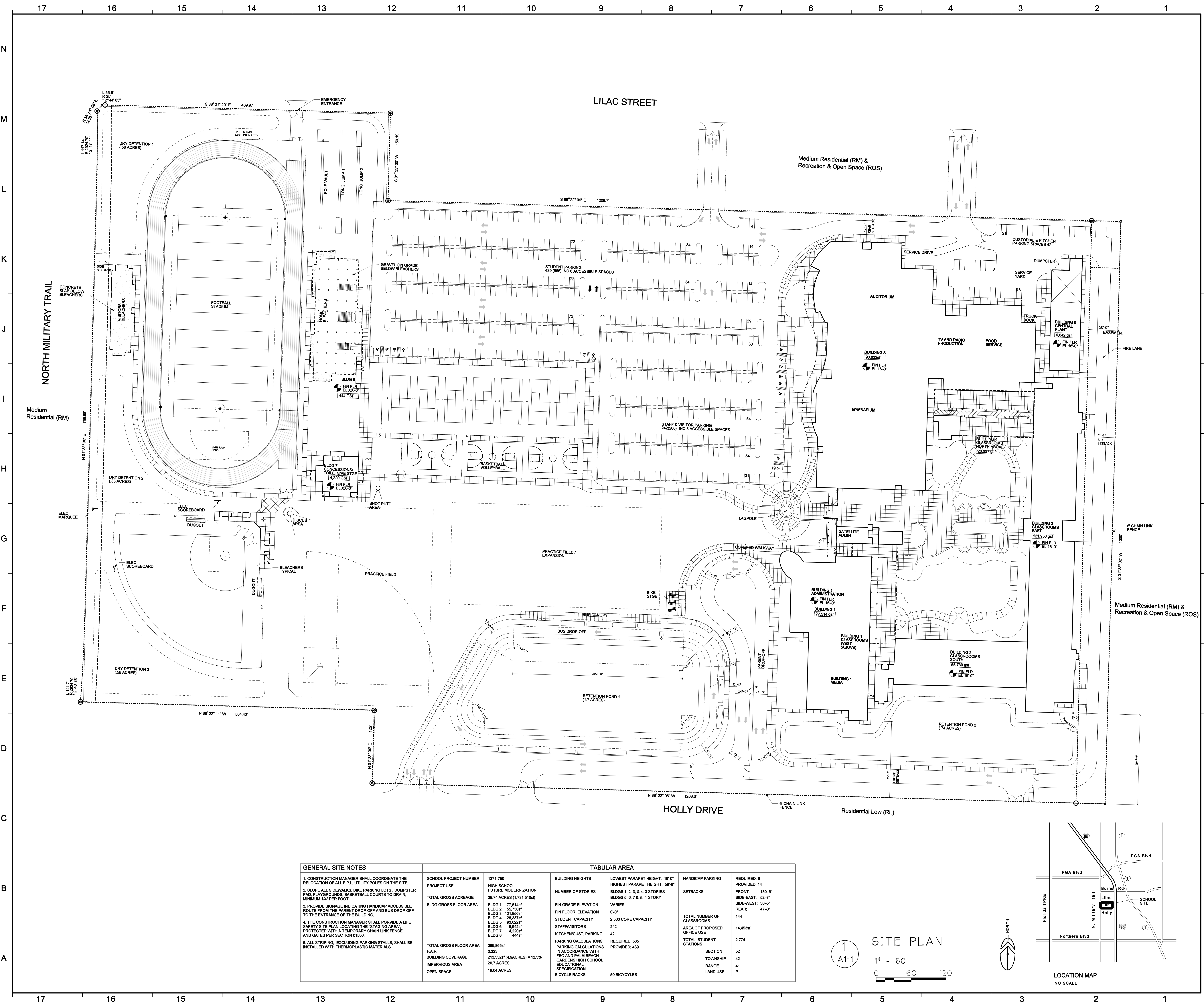

GENERAL SITE NOTES		TABULAR AREA	
1. CONSTRUCTION MANAGER SHALL COORDINATE THE RELOCATION OF ALL F.U. UTILITY POLES ON THE SITE.		SCHOOL PROJECT NUMBER	1371-750
2. SLOPE ALL SIDEWALKS, BIKE PARKING LOTS, DUMPSTER PAD, PLAYGROUNDS, BASKETBALL COURTS TO DRAIN. MINIMUM 1/4" PER FOOT.		PROJECT USE	HIGH SCHOOL FUTURE MODERNIZATION
3. PROVIDE SIGNAGE INDICATING HANDICAP ACCESSIBLE ROUTE FROM THE PARENT DROP-OFF AND BUS DROP-OFF TO THE ENTRANCE OF THE BUILDING.		TOTAL GROSS ACREAGE	39.74 ACRES (1,731,510sq)
4. THE CONSTRUCTION MANAGER SHALL PROVIDE A LIFE SAFETY SITE PLAN LOCATING THE "STAGING AREA" PROTECTED WITH A TEMPORARY CHAIN LINK FENCE AND GATES PER SECTION 01500.		BLDG GROSS FLOOR AREA	BLDG 1 77,514sf BLDG 2 56,759sf BLDG 3 121,969sf BLDG 4 28,337sf BLDG 5 83,029sf BLDG 6 8,842sf BLDG 7 4,209sf BLDG 8 444sf
5. ALL STRIPING, EXCLUDING PARKING STALLS, SHALL BE INSTALLED WITH THERMOPLASTIC MATERIALS.		TOTAL GROSS FLOOR AREA	385,865sf
		F.A.R.	0.223
		BUILDING COVERAGE	213.323sf (4 ACRES) = 12.3%
		IMPERVIOUS AREA	20.7 ACRES
		OPEN SPACE	19.04 ACRES
		BUILDING HEIGHTS	LOWEST PARAPET HEIGHT: 16'-0" HIGHEST PARAPET HEIGHT: 59'-0"
		NUMBER OF STORIES	BLDG 1, 2, 3, 4: 3 STORIES BLDG 5, 6, 7 & 8: 1 STORY
		FIN GRADE ELEVATION	VARIES
		FIN FLOOR ELEVATION	0'-0"
		STUDENT CAPACITY	2,500 CORE CAPACITY
		STAFF/VISITORS	242
		KITCHEN/CUST. PARKING	42
		PARKING CALCULATIONS	REQUIRED: 565 PROVIDED: 439
		PARKING CALCULATIONS IN ACCORDANCE WITH FBC AND PALM BEACH GARDENS HIGH SCHOOL EDUCATIONAL SPECIFICATION	
		BICYCLE RACKS	50 BICYCLES
		HANDICAP PARKING	REQUIRED: 9 PROVIDED: 14
		SETBACKS	FRONT: 130'-0" SIDE-EAST: 52'-7" SIDE-WEST: 30'-0" REAR: 47'-0"
		TOTAL NUMBER OF CLASSROOMS	144
		AREA OF PROPOSED OFFICE USE	14,453sf
		TOTAL STUDENT STATIONS	2,774
		SECTION	52
		TOWNSHIP	42
		RANGE	41
		LAND USE	P.

